



**TECHNICAL CHARACTERISTICS**

- Aluminium alloy construction
- Smooth operation
- High efficiency impeller
- Maintenance free
- Mountable in any position
- Recognized TEFC - cURus motor

**OPTIONS**

- Special voltages (IEC 38)
- Surface treatments

**ACCESSORIES**

- Inlet and/or inline filters
- Additional inlet/outlet silencers
- Safety valves
- Flow converting device
- Optional connectors

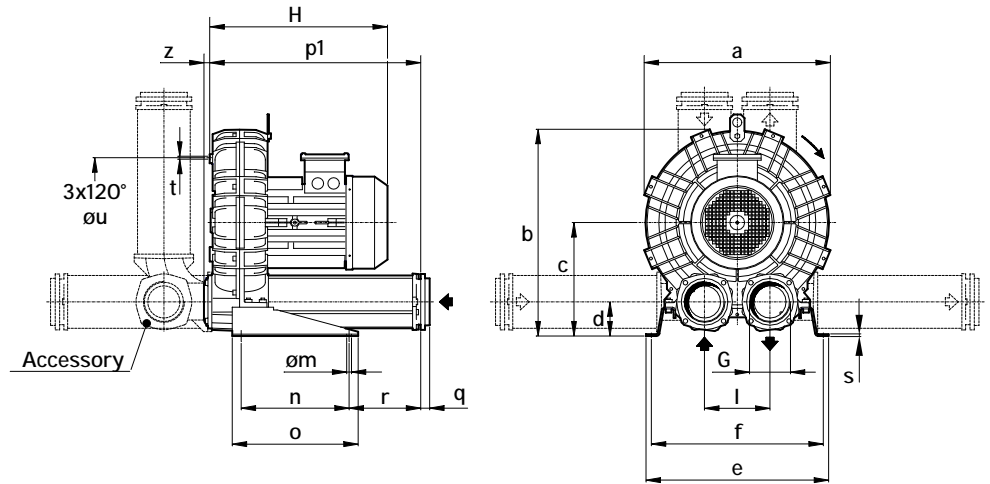

Dimensions in inches.  
Dimension for reference only.

| Model  | a     | b     | c     | d    | e     | f     | G      | l    | m    | n     | o     | p1    | q    | r    | s    | t  | u     | z    |
|--------|-------|-------|-------|------|-------|-------|--------|------|------|-------|-------|-------|------|------|------|----|-------|------|
| K07-MS | 16.69 | 18.84 | 10.59 | 3.23 | 18.43 | 17.24 | 3" NPT | 6.10 | 0.51 | 11.81 | 13.78 | 20.16 | 0.98 | 5.39 | 0.20 | M8 | 11.61 | 0.63 |
| K08-MS | 17.99 | 19.61 | 10.59 | 3.23 | 18.82 | 17.64 | 3" NPT | 6.10 | 0.51 | 11.81 | 13.78 | 20.16 | 0.98 | 5.39 | 0.20 | M8 | 12.2  | 0.63 |
| K09-MS | 19.37 | 22.09 | 12.40 | 3.78 | 20.00 | 18.82 | 4" NPT | 7.17 | 0.51 | 11.81 | 13.78 | 23.07 | 0.98 | 7.83 | 0.20 | M8 | 14.17 | 0.63 |
| K10-MS | 20.31 | 22.56 | 12.40 | 3.78 | 20.00 | 18.82 | 4" NPT | 7.17 | 0.51 | 11.81 | 13.78 | 23.07 | 0.98 | 7.83 | 0.20 | M8 | 14.17 | 0.63 |

| Model  | Maximum flow<br>cfm |                   | Installed power<br>Hp |                   | Maximum differential pressure<br>$\Delta p$ (In Hg) |                   | Noise level<br>Lp dB (A)<br>(1) |                   | Overall dimensions<br>H<br>Inches | Weight<br>Lbs |
|--------|---------------------|-------------------|-----------------------|-------------------|---|-------------------|---------------------------------|-------------------|-----------------------------------|---------------|
|        | 60 Hz<br>3500 rpm   | 50 Hz<br>2900 rpm | 60 Hz<br>3500 rpm     | 50 Hz<br>2900 rpm | 60 Hz<br>3500 rpm                                   | 50 Hz<br>2900 rpm | 60 Hz<br>3500 rpm               | 50 Hz<br>2900 rpm |                                   |               |
| K07-MS | 294                 | 243               | 4                     | 4                 | 3.0   | 4.6               | 77.7                            | 75.7              | 15.6                              | 116.2         |
|        |                     |                   | 5 1/2                 | 5 1/2             | 5.6   | 6.3               | 78.0                            | 76.0              | 16.3                              | 119.0         |
|        |                     |                   | 7 1/2                 | 7 1/2             | 8.9   | 8.9               | 78.3                            | 76.3              | 18.4                              | 160.5         |
|        |                     |                   | 10                    | -                 | 10.3  | -                 | 78.6                            | -                 | 19.1                              | 172.6         |
| K08-MS | 381                 | 316               | 5 1/2                 | 5 1/2             | 3.0   | 3.8               | 78.8                            | 76.8              | 16.3                              | 124.8         |
|        |                     |                   | 7 1/2                 | 7 1/2             | 5.2   | 6.6               | 79.1                            | 77.1              | 18.4                              | 166.5         |
|        |                     |                   | 10                    | 10                | 8.1   | 9.2               | 79.4                            | 77.4              | 19.1                              | 179.0         |
|        |                     |                   | 15                    | -                 | 9.6   | -                 | 79.7                            | -                 | 19.1                              | 192.0         |
| K09-MS | 471                 | 390               | 7 1/2                 | 7 1/2             | 3.7   | 4.6               | 79.3                            | 77.3              | 18.8                              | 186.3         |
|        |                     |                   | 10                    | 10                | 5.9   | 7.0               | 79.6                            | 77.6              | 19.5                              | 245.0         |
|        |                     |                   | 15                    | 15                | 9.6   | 10.4              | 80.1                            | 78.1              | 22.0                              | 212.0         |
| K10-MS | 556                 | 460               | 7 1/2                 | 7 1/2             | 2.4   | 3.8               | 79.4                            | 77.4              | 18.8                              | 189.6         |
|        |                     |                   | 10                    | 10                | 4.4   | 5.9               | 79.7                            | 77.7              | 19.5                              | 202.0         |
|        |                     |                   | 15                    | 15                | 8.1   | 9.9               | 80.2                            | 78.2              | 19.6                              | 215.0         |
|        |                     |                   | 20                    | -                 | 9.6   | -                 | 80.5                            | -                 | 22.0                              | 248.0         |

(1) Noise measured at 1 m distance with inlet and outlet ports piped, in accordance to ISO 3744.

- For proper use, the blower should be equipped with inlet filter and safety valve; other accessories available on request.
- Ambient temperature from +5° to +104°F.
- Specifications subject to change without notice.

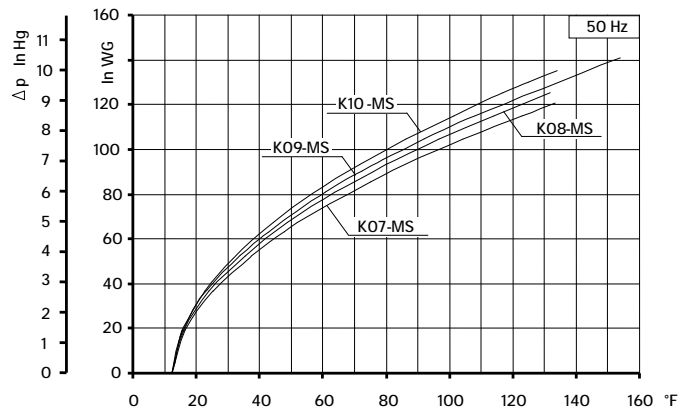
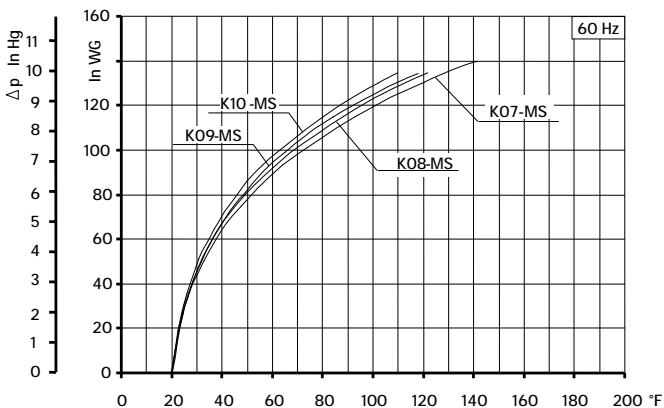
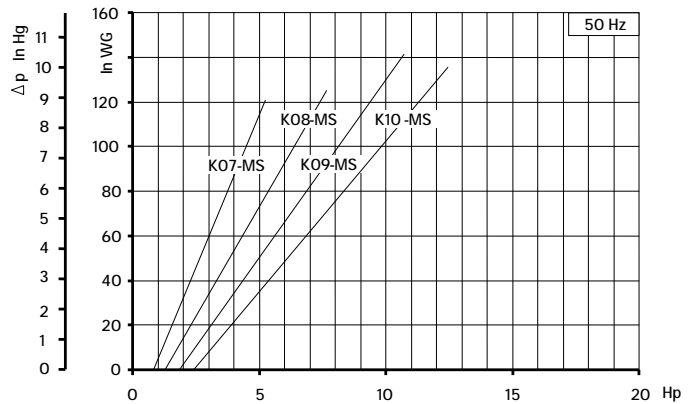
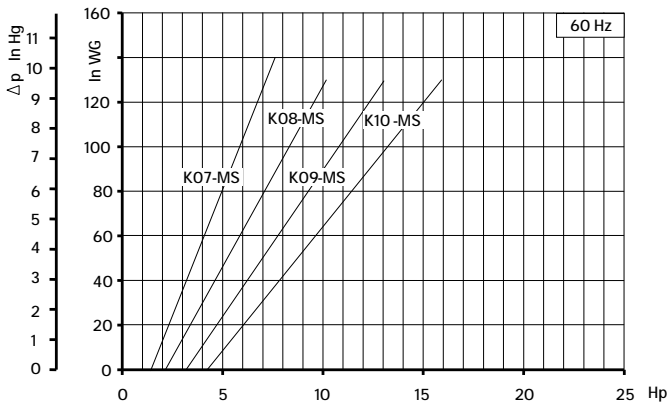
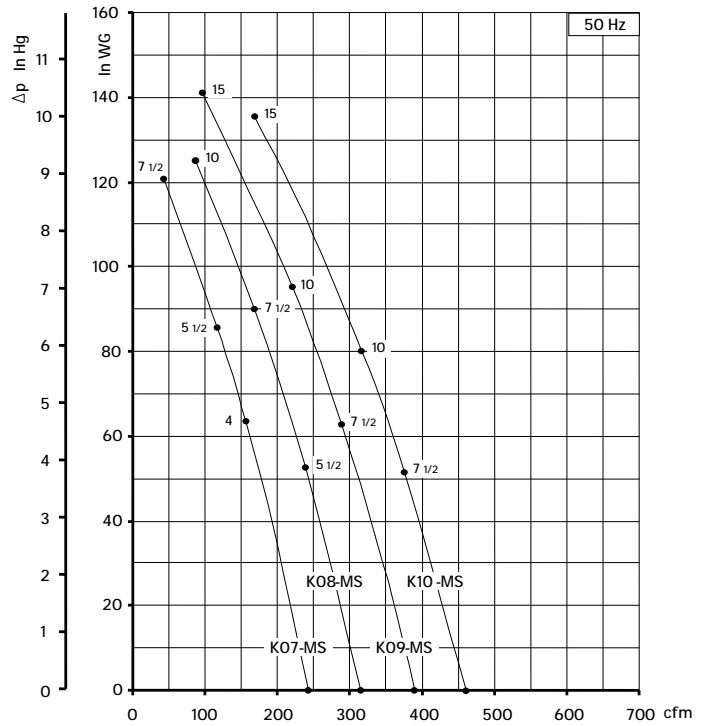
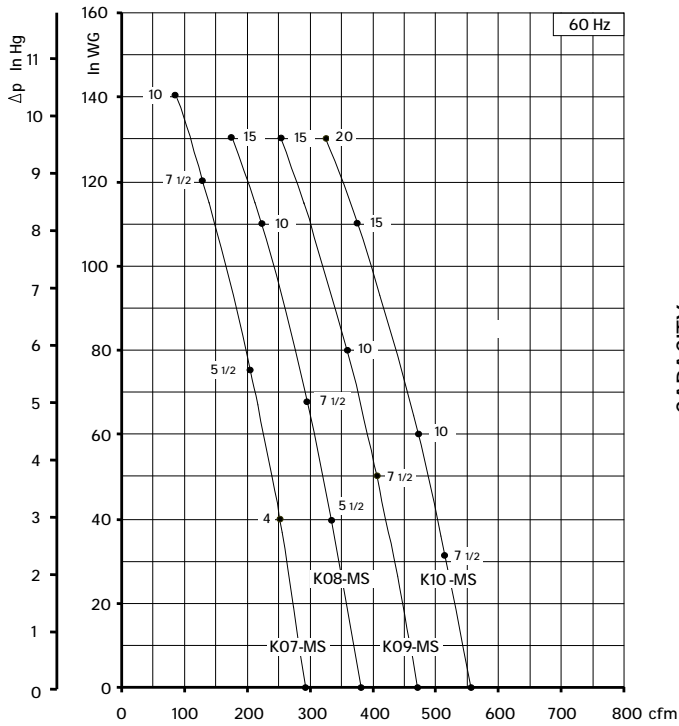

Curves refer to air at 68° F temperature, measured at inlet port and 29.92 In Hg atmospheric backpressure (abs).  
 Values for flow, power consumption and temperature rise: +/-10% tolerance.  
 Data subject to change without notice.