

●Contents of diaphragm repair kit (Please confirm the contents of the repair kit)

①Diaphragm



(2pcs)

②Diaphragm holder

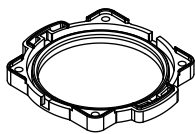

(2pcs)

③Valve box

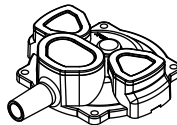

(2pcs)

④Filter

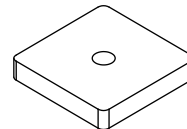

(1pcs)

⑤Tank base packing
TKO-150/200/250

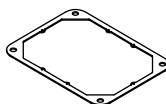

(1pcs)

⑥Tank base packing
TKO-300/400/500

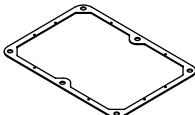

(1pcs)

⑦Nut



(4pcs)

⑧Magnet support jig

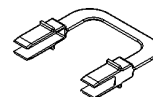

(1pcs)



○Always disconnect power before servicing. Failure to do so could result in electrical shock, personal injury or death.

- ◎The replacement parts might be a little bit different from the picture, but the replacement method remains applicable.
- ◎Two sets of the parts as shown in the picture will be used in the replacement of TKO-300/400/500 in the same way.
- ◎After maintenance ensure the pump is fully sealed and has a fresh, clean, dry air supply to avoid ingress foul air to filter

◆Cleaning and replacement of filter

1) Undo the truss head screw and remove the filter cover.

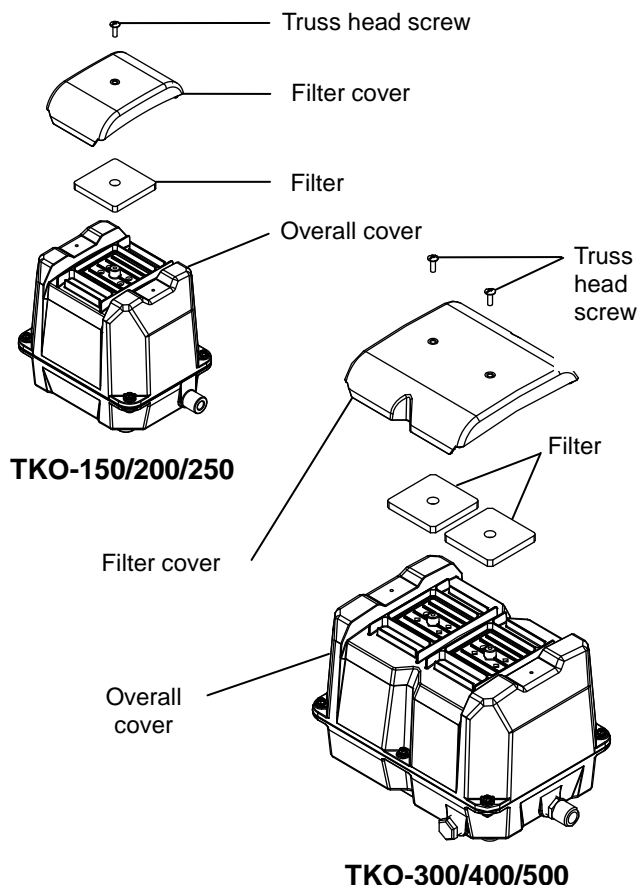

2) Remove the filter and shake out dust by hand, if cleaning.

3) Replace cleaned or new filter into place and replace cover and fix with screw.

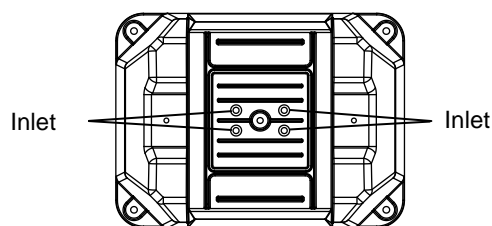

TKO-150/200/250 (inlet 4pcs)

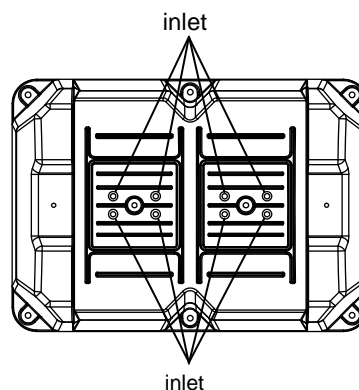

TKO-300/400/500 (inlet 8pcs)

◆ Replacement of diaphragm and valve box

- 1) Undo the corner bolts with a screwdriver and remove the overall cover.

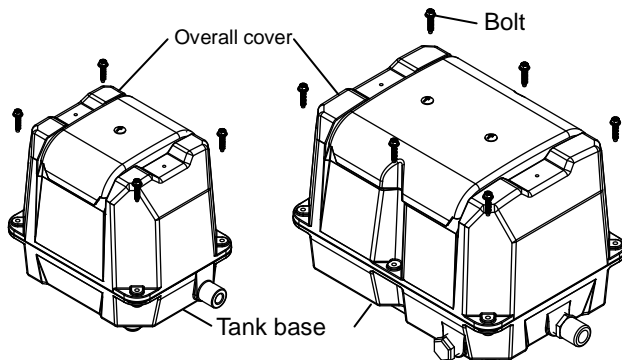

TKO-150/200/250

TKO-300/400/500

- You may need to use a lever to pry open the cover

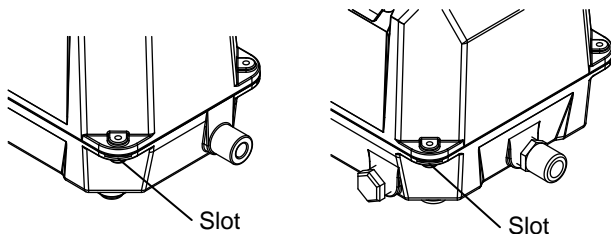

TKO-150/200/250

TKO-300/400/500

- 2) Remove the shock absorber. Undo the screws with a screwdriver and remove the holder cover

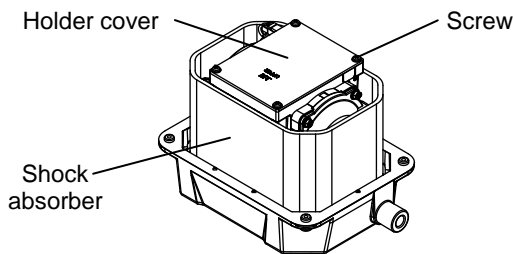

- 3) Undo the screws of the valve box with a screwdriver and pull out the outlet of the valve box from the connecting rubber

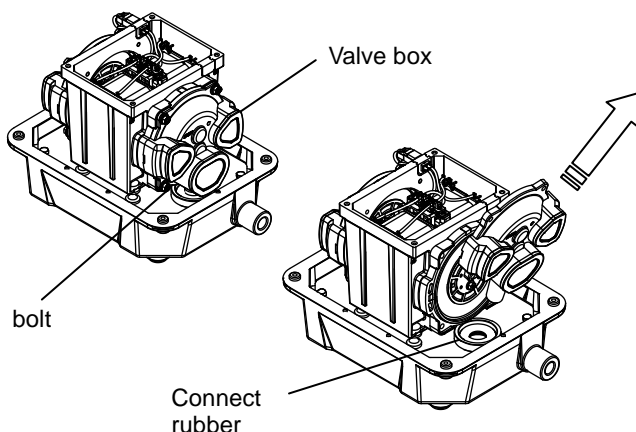

- You may need to use a lever to pry the valve box open.

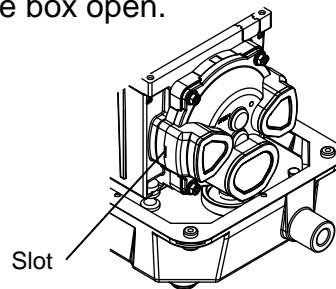

- 4) Undo the nuts, replace the diaphragm holder from the magnet holder.

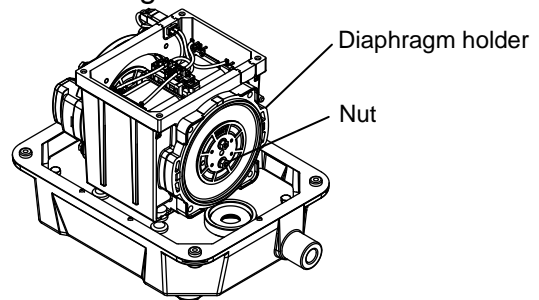

CAUTION

○Magnetic force is very strong, please be careful during operation.

- Inappropriate operation may cause personal injury.

- ※Keep the bulge upward when replace the magnet holder.

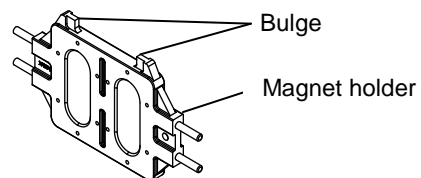

- 5) Insert the magnet support jig in four corners between the magnet holder and the core .

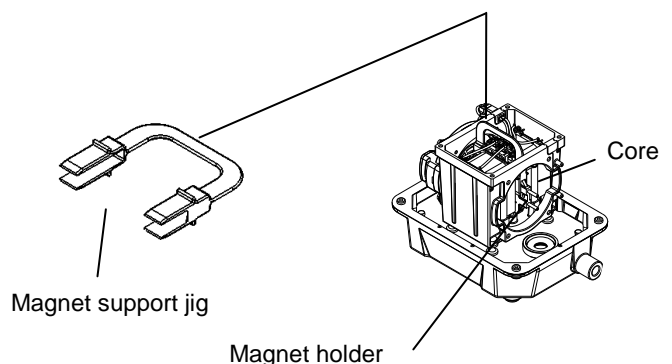

6) Insert the protrusion of the new diaphragm in the locating notch of the diaphragm holder.

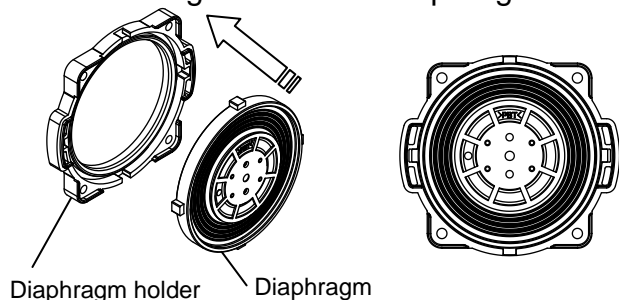

NOTE

● Press the diaphragm edges in the diaphragm holder firmly.

CAUTION ! If the diaphragm is not properly in the diaphragm holder, it will cause shortened diaphragm life.

7) With the magnet support jig inserted, replace the magnet holder and the diaphragm, installing into the solenoid holder.

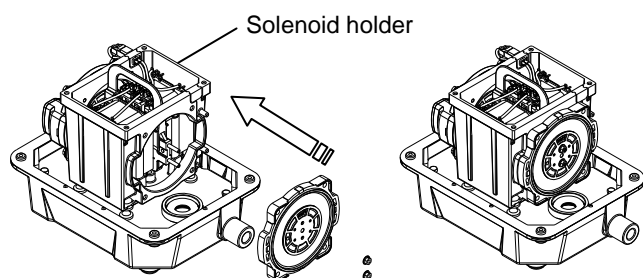

NOTE

● Please replace the diaphragm and valve box for both side.

CAUTION ! Not replacing the old parts may cause damage to the pump.

8) Replace the valve box.

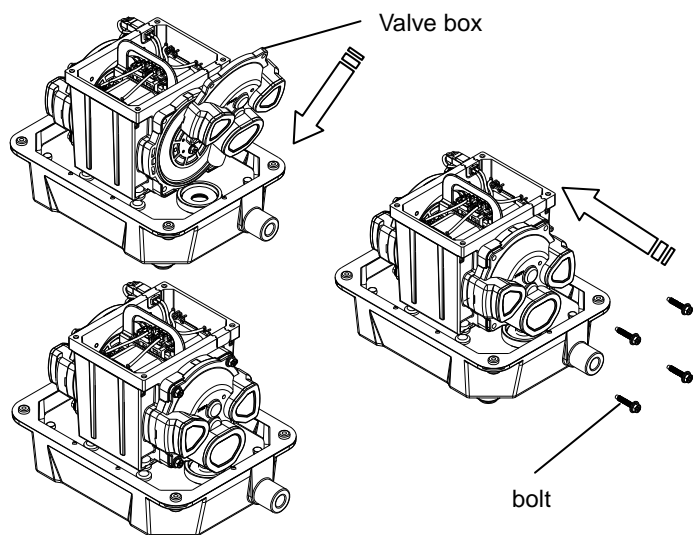

9) After the completion of the replacement parts, pull out the magnet support jig. Make sure the magnet holder is in the middle of the iron core. If not, please reset the magnet holder.

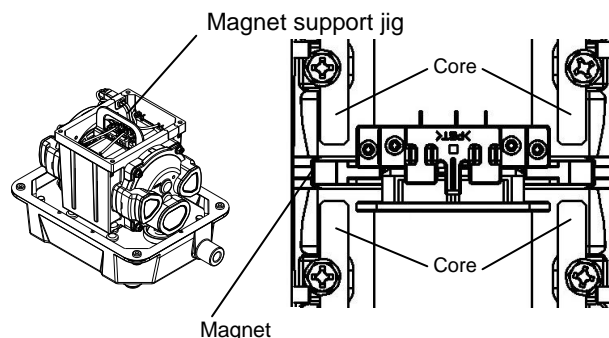

NOTE

● Please confirm magnet holder always in the middle.

CAUTION ! If diaphragm is not properly placed in the diaphragm holder, the magnet position may be misaligned causing shortened diaphragm life, performance degradation.

10) Set the slider in the middle.

Rest of auto stopper



WARNING

○ Cut the power before you service the pump.

● Do not touch the terminal of the switch. If hazard is ignored, it may cause electric shock.

● If not disconnected the magnet starts moving upon reset of auto stopper, it may cause personal injury.

If the slider deviates from the middle, please set it back as the picture below.

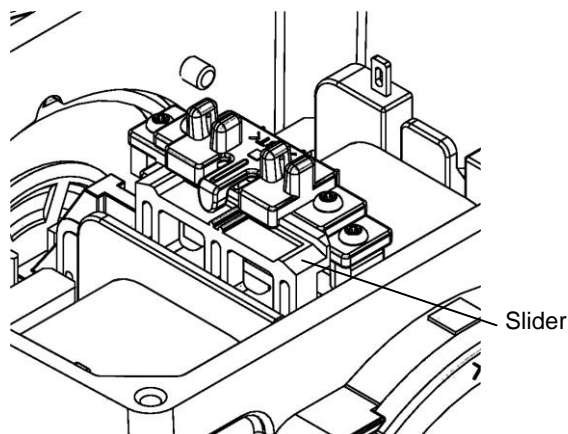

You will hear the auto stopper click into position

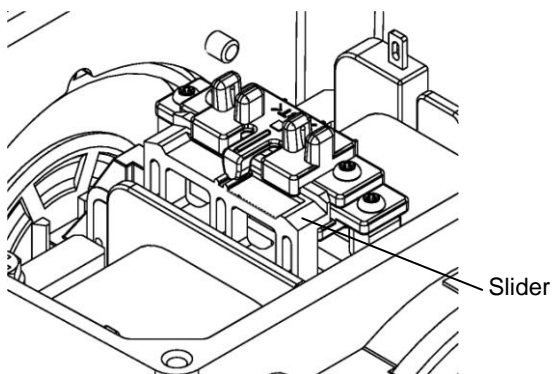

11) Connect power , confirm whether the magnet holder is moving in the middle and whether air blowing out properly, then remove the plug and start next operation.



WARNING

○ Do not touch the live parts.

● Touching the live parts will result in electric shock.

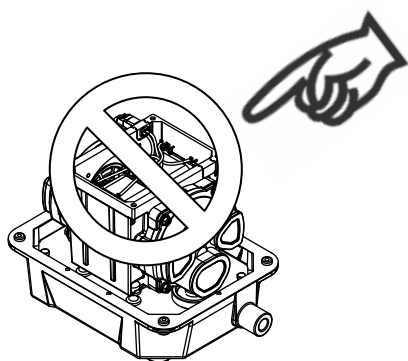

12) Fasten the holder cover with the screw, put the shock absorber back.

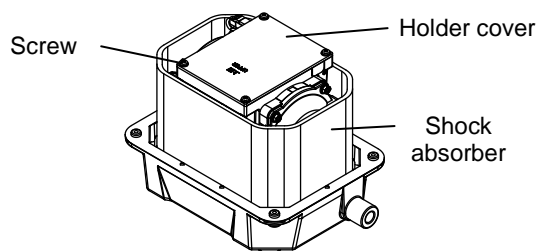

13) Replace the tank base packing.

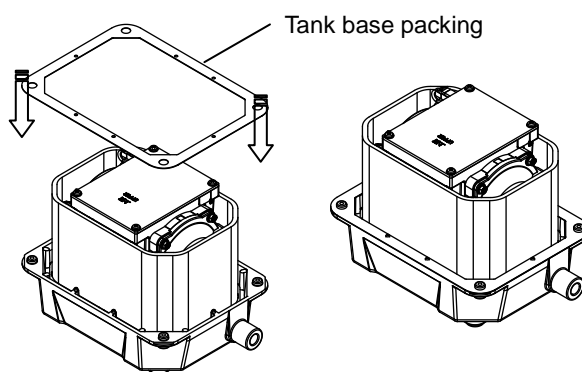

14) Use nuts and screw to fix carefully.

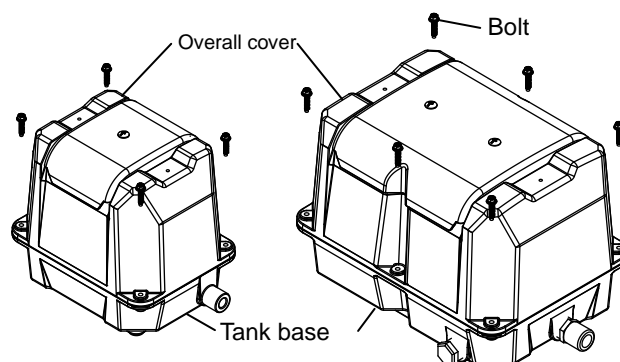

TKO-150/200/250

TKO-300/400/500

After the assembly, connect power and check if there is air out or any noise, then install back to the original position.

INSTRUCTIONS

- Please pay special attention to the marks below in this manual.



WARNING

High potential risks resulting from improper handling, as it can cause death or serious injuries.



CAUTION

High potential risks resulting from improper handling, as in some cases it can cause serious injuries.

- NOTE Make additional remarks to the point in this manual. Please read it carefully.



Keep this manual available for review in case of need.

SECOH SHANGHAI MEC LTD.

201907-00